



FICO HI-TECH (PVT) LIMITED

power of applied intelligence

COMPANY CATALOGUE

FICOHITECH PVT LIMITED, FICO STREET, CLIMAXABAD,
GT ROAD, GUJRANWALA, PAKISTAN
T: 00-92-345-9440077 (EXT: 104) | M: 00-92-321-7422155 | O: 00-92-3255653 - EXT: 104
E: abdulaziz@ficohitech.com | sales@ficohitech.com
W: www.ficohitech.com



SINCE 1952

CONTENTS

	INSTRUMENT TRANSFORMER	
	INTRODUCTION OF CURRENT TRANSFORMER	1
	RLC SERIES (15 VA)	2
	SLC SERIES (10 VA)	3
	ILC SERIES (INNOVATIVE CLASS)	4
	ELC SERIES (ECONOMICAL CLASS)	5
	SCLC SERIES SPLIT TYPE MODEL	6
	SPECIAL SIZE CT	7
	TAB CT	8
	MLC RESIN CAST CT	9
	SUMMATION TYPE CT	10
	CORE BALANCE CT	11
	INDUSTRIAL AUTOMATION CONTROL (PANEL ACCESSORIES)	
	INTRODUCTION OF PANEL ACCESSORIES	12
	SELECTOR SWITCH	13
	PUSH BUTTON	14
	INDICATION LIGHT	15
	PANEL METER (DIGITAL & ANALOGUE)	
	INTRODUCTION OF PANEL METERS	16
	VOLT METERS & AMMETER (DIGITAL)	17
	DIGITAL ANALYSER	18
	INDICATION LIGHT	19
	VAF METER	20
	PANEL METER (ANALOGUE)	21
	TRANSMISSION LINE EQUIPMENT	
	FUSE CUTOFF PORCELAIN TYPE (WAPDA APPROVED)	22
	FUSE CUTOFF POLYMER TYPE (KE APPROVED)	23
	FUSE LINK KE APPROVED	24
	FUSE LINK WAPDA APPROVED	25
	TRANSMISSION LINE HARDWARE	26
	APPROVALS & CERTIFICATION	27



CURRENT TRANSFORMER (low voltage)

INTRODUCTION

Current Transformer was used to change the high primary current to low secondary current. Connected with the Panel Meter or Relay, they can help to measure the current or protect the equipments which were connected to the high voltage line

THE LINK BETWEEN HEAVY CURRENT AND MEASUREMENT TECHNOLOGY

The right current transformer for every application

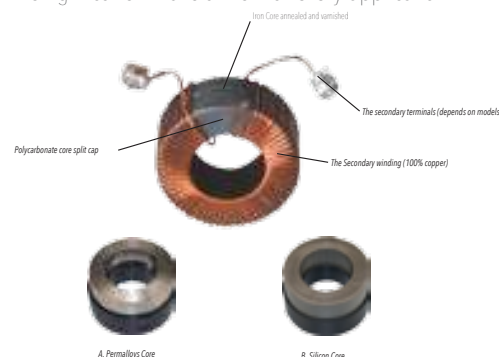

Anyone wanting to record energy consumption, must measure currents. This is done by using a current transformer to measure the magnetic field created by the current. In principle, the current transformer is similar to a power transformer. The primary circuit is formed by the line to be measured, the connection to the measurement device forms the secondary circuit. As a result, on the one hand there is a galvanic separation between the measurement device and the current circuit to be measured and on the other hand, the size of the current can be transformed down by a defined ratio to a size suitable for the measurement device:



For example, a high-power 320 Amp line can be reduced by means of a 500:5 transformer to more convenient 3.2 Amps. At the same time, the measurement equipment is protected by the so-called saturation effect in the event of a fault, e.g. with a short-circuit. This phenomenon means that the magnetisation of a material through a magnetic field only rises until it reaches saturation point. The current in the secondary circuit is thus automatically limited through the physical characteristics of the current transformer.

The appropriate combination of measurement device and transformer is critical for the quality and accuracy of a measurement: As with measurement devices, there are permissible nominal currents and accuracy classes with transformers too, the knowledge of which is essential for correct measurement.

CT consist of primary winding, secondary winding, magnetic core and insulated body. The high-grade silicon is annealed, varnished then insulated with polycarbonate core caps. The secondary winding is toroidally wound by high precision semi-automatic machinery. For the tape wound ring type current transformer, the PEW coated windings are then covered with elephantite paper, varnished and double-tapped with PVS tapes. For the encapsulated type current transformer, the windings are enclosed in a compact and heat resistant split cap.



Installed current transformer in the field. The mounting assembly can be shown for the reference.

Need to open the bar and insert the current transformer.

Current transformers - DEWA & SEC approved series

INNOVATIVE MODEL

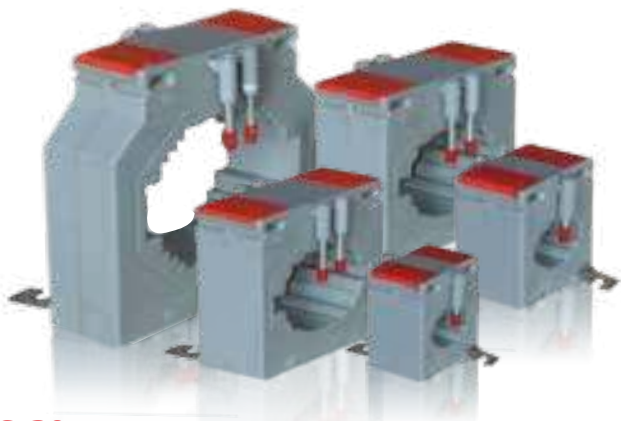

ILC-30

Primary current (i)	CL (0.5)	CL (1)	CL (3)	Primary conductor (bar)	Primary conductor (round)
30A	-	-	-	20mm x 30mm	25MM
60A	-	-	-	20mm x 30mm	25MM
100A	1VA	1VA	1VA	20mm x 30mm	25MM
150A	1.5VA	1.5VA	1.5VA	20mm x 30mm	25MM
200A	2.5VA	2.5va	2.5VA	20mm x 30mm	25MM

ILC-40

Primary current (i)	CL (0.5)	CL (1)	CL (3)	Primary conductor (bar)	Primary conductor (round)
30A	-	-	1VA	40mm x 10mm	30MM
60A	-	1VA	1.5VA	40mm x 10mm	30MM
100A	1VA	1.5VA	2.5VA	40mm x 10mm	30MM
150A	1.5VA	2.5va	3.75VA	40mm x 10mm	30MM
200A	2.5VA	3VA	5VA	40mm x 10mm	30MM
300A	5VA	5va	7.5VA	40mm x 10mm	30MM
400A	7.5VA	7.5va	10VA	40mm x 10mm	30MM

ILC-60

Primary current (i)	CL (0.5)	CL (1)	CL (3)	Primary conductor (bar)	Primary conductor (round)
100A	-	-	2.5VA	60mm x 10mm, 50mmx30mm	50mm
200A	1VA	2.5va	3.75VA	60mm x 10mm, 50mmx30mm	50mm
300A	1.5VA	3VA	5VA	60mm x 10mm, 50mmx30mm	50mm
400A	2.5VA	5va	7.5VA	60mm x 10mm, 50mmx30mm	50mm
600A	5VA	7.5va	10VA	60mm x 10mm, 50mmx30mm	50mm
800A	7.5VA	10va	15VA	60mm x 10mm, 50mmx30mm	50mm

ILC-80

Primary current (i)	CL (0.5)	CL (1)	CL (3)	Primary conductor (bar)	Primary conductor (round)
200A	1.5VA	2.5va	5VA	80mm x 10mm, 60mmx30mm	65mm
300A	2.5VA	5VA	7.5VA	80mm x 10mm, 60mmx30mm	65mm
400A	5VA	7.5va	10VA	80mm x 10mm, 60mmx30mm	65mm
600A	7.5VA	10va	15VA	80mm x 10mm, 60mmx30mm	65mm
800A	10VA	12.5va	25VA	80mm x 10mm, 60mmx30mm	65mm
1200A	12.5VA	15va	30VA	80mm x 10mm, 60mmx30mm	65mm

ILC-100

Primary current (i)	CL (0.5)	CL (1)	CL (3)	Primary conductor (bar)	Primary conductor (round)
1000A	5VA	7.5VA	10VA	100mm x 30mm, 80mmx50mm	80mm
1200A	7.5VA	10VA	15VA	100mm x 30mm, 80mmx50mm	80mm
1600A	10VA	15VA	25VA	100mm x 30mm, 80mmx50mm	80mm
2000A	15VA	25VA	30va	100mm x 30mm, 80mmx50mm	80mm
2400A	25VA	30va	40VA	100mm x 30mm, 80mmx50mm	80mm

Technical features

SPECIFICATIONS	
Reference specification	EN/IEC 61869-1, 61869-2
Rated primary current Ipr:	1600A
Working frequency:	47...63Hz
Rated continuous thermal current Icth:	100% Ipr
Rated short-time thermal current Ith:	< 60Ipr
Rated dynamic current Idyn :	2.5Ith
Instrument security factor (FS):	≤ 5
Rated secondary current Isr :	5
Max. power dissipation	≤ 20W
Allowed max cable or busbar temperature:	125°C
INSULATION REQUIREMENTS	
Type	Dry transformer, air insulation
Highest voltage for equipment Um:	0.72kV r.m.s.
Rated insulation level:	3kV r.m.s. 50Hz/1min
ENVIRONMENTAL CONDITIONS	
Nominal temperature range:	-25...50°C
Limit temperature range for storage:	-40...85°C
Relative humidity:	≤ 85%
Suitable for tropical climates	yes
CONNECTION	
Primary winding:	Passing bus bar
Secondary winding:	tightening by nut M4
MECHANICAL FEATURES	
Housing material:	self extinguishing polycarbonate
Mounting:	screw type on bar
Weight:	1150 gr

Dimensions

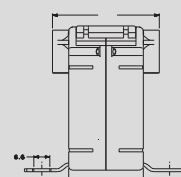
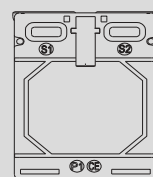

Wiring diagrams

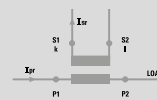

MODEL	A (mm)	B (mm)	C (mm)
ILC 30	78	50	32
ILC 40	78	62	40
ILC 60	110	86	45
ILC 80	128	104	45
ILC 100	155	140	62

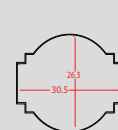

ILC-30

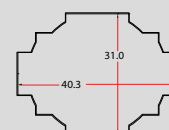

ILC-40

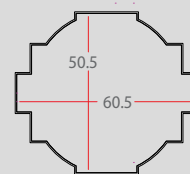

ILC-60

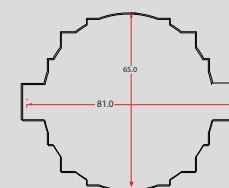

ILC-80

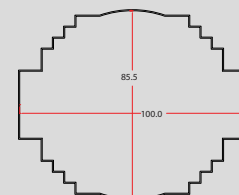

ILC-100

NOTE : On request orders for types different from table are accepted. 1A Secondary available

FICO HI-TECH (pvt) ltd

power of applied intelligence

FICO street climaxabad, GT road, gujranwala, Pakistan.

TEL : (0092)55325553-4
 MOB : (0092)3217422155
 E-MAIL : sales@fichohitech.com
 WEBSITE : www.fichohitech.com





SINCE 1952

Current transformers - ELC SERIES ECONOMICAL MODEL

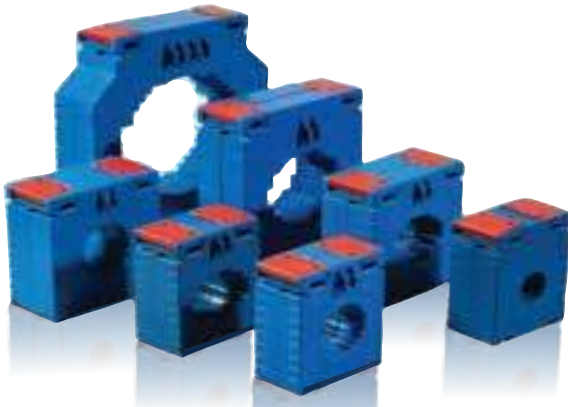

ELC - 20

I (pri)	I (sec)	Cl:1	Primary conductor	Round conductor
30A	5A	1VA PT1	-	20MM
60A	5A	1.5VA PT1	-	20MM

ELC - 30 s

I (pri)	I (sec)	Cl:1	Primary conductor	Round conductor
30A	5A	2.5VA - PT 4	30mmx10mm	30mm
60A	5A	2.5VA - pt 2	30mmx10mm	30mm
100A	5A	2.5VA	30mmx10mm	30mm
150A	5A	2.5VA	30mmx10mm	30mm
200A	5A	2.5VA	30mmx10mm	30mm
300A	5A	2.5VA	30mmx10mm	30mm
400A	5A	2.5VA	30mmx10mm	30mm

ELC - 40 s

I (pri)	I (sec)	Cl:1	Primary conductor	Round conductor
30A	5A	2.5VA - PT 4	40mmx10mm	30mm
60A	5A	2.5VA - pt 2	40mmx10mm	30mm
100A	5A	2.5VA	40mmx10mm	30mm
150A	5A	2.5VA	40mmx10mm	30mm
200A	5A	2.5VA	40mmx10mm	30mm
300A	5A	2.5VA	40mmx10mm	30mm
400A	5A	2.5VA	40mmx10mm	30mm

ELC - 30

I (pri)	I (sec)	Cl:1	Primary conductor	Round conductor
30A	5A	5VA (PT-4)	30mmx10mm	30mm
60A	5A	5VA (PT-2)	30mmx10mm	30mm
100A	5A	5VA	30mmx10mm	30mm
150A	5A	5VA	30mmx10mm	30mm
200A	5A	5VA	30mmx10mm	30mm
300A	5A	5VA	30mmx10mm	30mm
400A	5A	5VA	30mmx10mm	30mm

ELC - 40

I (pri)	I (sec)	Cl:1	Primary conductor	Round conductor
30A	5A	5VA (PT-4)	40mmx10mm	30mm
60A	5A	5VA (PT-2)	40mmx10mm	30mm
100A	5A	5VA	40mmx10mm	30mm
150A	5A	5VA	40mmx10mm	30mm
200A	5A	5VA	40mmx10mm	30mm
300A	5A	5VA	40mmx10mm	30mm
400A	5A	5VA	40mmx10mm	30mm

ELC - 60

I (pri)	I (sec)	Cl:1	Primary conductor	Round conductor
600A	5A	10VA	60mmx10mm, 50mmx30mm	50mm
800A	5A	10VA	60mmx10mm, 50mmx30mm	50mm
1000A	5A	10VA	60mmx10mm, 50mmx30mm	50mm
1200A	5A	10VA	60mmx10mm, 50mmx30mm	50mm

ELC - 80

I (pri)	I (sec)	Cl:1	Primary conductor	Round conductor
800A	5A	10VA	80mmx10mm, 60mmx30mm	66mm
1000A	5A	10VA	80mmx10mm, 60mmx30mm	66mm
1200A	5A	10VA	80mmx10mm, 60mmx30mm	66mm
1600A	5A	10VA	80mmx10mm, 60mmx30mm	66mm

ELC - 100

I (pri)	I (sec)	Cl:1	Primary conductor	Round conductor
1000A	5A	10VA	100mmx30mm, 80mmx50mm	-
1200A	5A	10VA	100mmx30mm, 80mmx50mm	-
1600A	5A	10VA	100mmx30mm, 80mmx50mm	-
2000A	5A	10VA	100mmx30mm, 80mmx50mm	-
2400A	5A	10VA	100mmx30mm, 80mmx50mm	-
3000A	5A	10VA	100mmx30mm, 80mmx50mm	-
3200A	5A	10VA	100mmx30mm, 80mmx50mm	-

Technical features

SPECIFICATIONS		
Reference specification	EN/IEC 61869-1, 61869-2	
Rated primary current I _{pr} :	250...2000A	300...2500A
Working frequency:	47...63Hz	
Rated continuous thermal current I _{th} :	100% I _{pr}	
Rated short-time thermal current I _{th} :	< 60I _{pr}	
Rated dynamic current I _{dyn} :	2.5I _{th}	
Instrument security factor (FS):	≤ 5	
Rated secondary current I _{sr} :	5 - 1A	
Max. power dissipation	≤ 19W	
Allowed max cable or busbar temperature:	125°C	

INSULATION REQUIREMENTS	
Type	Dry transformer, air insulation
Highest voltage for equipment U _m :	0.72kV r.m.s.
Rated insulation level:	3kV r.m.s. 50Hz/1min

ENVIRONMENTAL CONDITIONS	
Nominal temperature range:	-25...50°C
Limit temperature range for storage:	-40...85°C
Relative humidity:	≤ 85%
Suitable for tropical climates	yes

CONNECTION	
Primary winding:	Passing bus bar
Secondary winding:	tightening by nut M4

MECHANICAL FEATURES	
Housing material:	self extinguishing polycarbonate
Mounting:	screw type on bar
Weight:	

Dimensions ELC

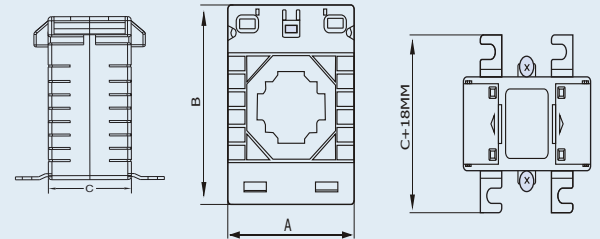

MODEL	A (mm)	B (mm)	C (mm)
ELC-20	62	77	36
ELC-30S	80	87	41
ELC-40S	80	87	41
ELC-30	63	78	35
ELC-40	63	78	35
ELC-60	100	118	41
ELC-80	110	130	40
ELC-100	145	154	38

Wiring diagrams

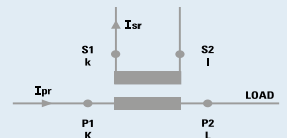

DIMENSIONAL DRAWING

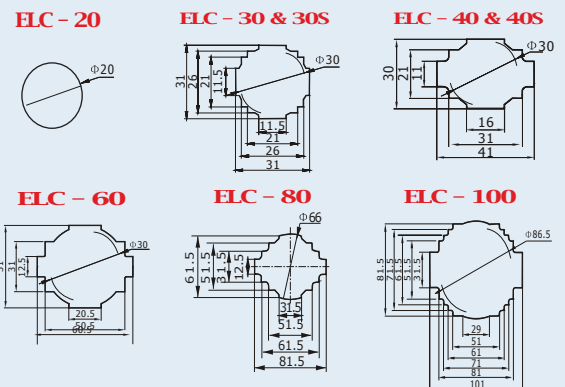

NOTE : On request orders for types different from table are accepted. 1A Secondary available



FICO hi-tech (pvt) ltd
power of applied intelligence

FICO street climaxabad, GT road, gujranwala, Pakistan.

TEL: (0092) 55325553-4
MOB: (0092) 3217422155
E-MAIL: sales@fichitech.com
WEBSITE: www.fichitech.com





SINCE 1952

Current transformers - SLC series (10 VA BURDEN) ROUND & RECTANGULAR MODEL



Cable/passing bar single-phase current transformers



MODEL	Ratio	PT	Class 1	ROUND CONDUCTOR MAX	BAR SIZE MAX
SLC - 30	30/5A	4	10VA	30MM	10MM X 30MM
SLC - 30	50/5A	2	10VA	30MM	10MM X 30MM
SLC - 30	60/5A	1	10VA	30MM	10MM X 30MM
SLC - 30	100/5A	1	10VA	30MM	10MM X 30MM
SLC - 30	150/5A	1	10VA	30MM	10MM X 30MM
SLC - 30	200/5A	1	10VA	30MM	10MM X 30MM
SLC - 30	300/5A	1	10VA	30MM	10MM X 30MM
SLC - 40	400/5A	1	10VA	40MM	10MM X 40MM
SLC - 40	500/5A	1	10VA	40MM	10MM X 40MM
SLC - 40	600/5A	1	10VA	40MM	10MM X 40MM
SLC - 50	400/5A	1	10VA	50MM	20MM X 50MM
SLC - 50	500/5A	1	10VA	50MM	20MM X 50MM
SLC - 50	600/5A	1	10VA	50MM	20MM X 50MM
SLC - 50	800/5A	1	10VA	50MM	20MM X 50MM
SLC - 50	1000/5A	1	10VA	50MM	20MM X 50MM
SLC - 50	1200/5A	1	10VA	50MM	20MM X 50MM
SLC - 65	600/5A	1	10VA	65MM	-
SLC - 65	800/5A	1	10VA	65MM	-
SLC - 65	1000/5A	1	10VA	65MM	-
SLC - 65	1200/5A	1	10VA	65MM	-
SLC - 65	1600/5A	1	10VA	65MM	-
SLC - 65	2000/5A	1	10VA	65MM	-
SLC - 100	1200/5A	1	10VA	-	100MM X 50MM
SLC - 100	1600/5A	1	10VA	-	100MM X 50MM
SLC - 100	2000/5A	1	10VA	-	100MM X 50MM
SLC - 125	2500/5A	1	10VA	-	125MM X 50MM
SLC - 125	3000/5A	1	10VA	-	125MM X 50MM
SLC - 125	3200/5A	1	10VA	-	125MM X 50MM
SLC - 125	4000/5A	1	10VA	-	125MM X 50MM

Technical features

SPECIFICATIONS	
Reference specification	EN/IEC 61869-1, 61869-2
Rated primary current Ipr:	30A TO 4000A
Working frequency:	47...63Hz
Rated continuous thermal current Icth:	100% Ipr
Rated short-time thermal current Ith:	< 60Ipr
Rated dynamic current Idyn:	2,5Ith
Instrument security factor (FS):	≤ 5
Rated secondary current Isr:	5
Max. power dissipation	≤ 20W
Allowed max cable or busbar temperature:	125°C
INSULATION REQUIREMENTS	
Type	Dry transformer, air insulation
Highest voltage for equipment Um:	0.72kV r.m.s.
Rated insulation level:	3kV r.m.s. 50Hz/1min
ENVIRONMENTAL CONDITIONS	
Nominal temperature range:	-25...50°C
Limit temperature range for storage:	-40...85°C
Relative humidity:	≤ 85%
Suitable for tropical climates	yes
CONNECTION	
Primary winding:	Passing bus bar
Secondary winding:	tightening by nut M4
MECHANICAL FEATURES	
Housing material:	self extinguishing polycarbonate
Mounting:	screw type on bar
Weight:	-

Dimensions SLC

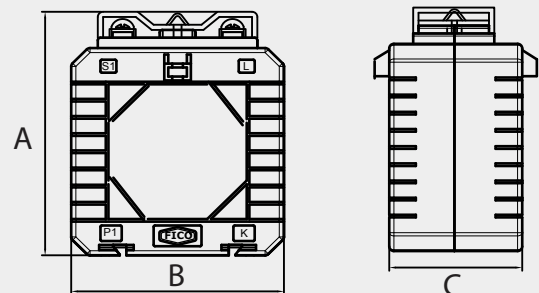

MODEL	A (mm)	B (mm)	C (mm)
SLC 30	96	80	50
SLC 40	96	80	50
SLC 50	126	104	52
SLC 65	142	120	52
SLC 100	126	142	50
SLC 125	138	170	50

Wiring diagrams



SLC 30

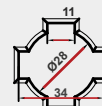

SLC 40



SLC 50

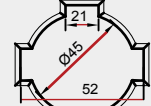

SLC 65



SLC 100

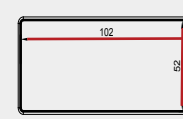

SLC 125

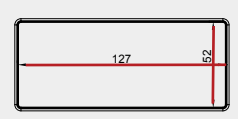

NOTE: On request orders for types different from table are accepted. 1A Secondary available



FICO hi-tech (pvt) ltd

power of applied intelligence

FICO street climaxabad, GT road, gujranwala, Pakistan.

TEL: (0092) 55325553-4
MOB: (0092) 3217422155
E-MAIL: sales@fichitech.com
WEBSITE: www.fichitech.com





SINCE 1952

Current transformers - RLC series (15 VA BURDEN) ROUND & RECTANGULAR MODEL



Cable/passing bar single-phase current transformers



RLC 30

I (pri)	I (sec)	Cl:1	Round conductor
30A	5A	15VA - PT 4	30mm
60A	5A	15VA - pt 2	30mm
100A	5A	15VA	30mm
150A	5A	15VA	30mm
200A	5A	15VA	30mm
250A	5A	15VA	30mm
300A	5A	15VA	30mm

RLC 50

I (pri)	I (sec)	Cl:1	Round conductor
400A	5A	15VA	50mm
500A	5A	15VA	50mm
600A	5A	15VA	50mm

RLC 65

I (pri)	I (sec)	Cl:1	Round conductor
400A	5A	15VA	65mm
500A	5A	15VA	65mm
600A	5A	15VA	65mm
800A	5A	15VA	65mm
1000A	5A	15VA	65mm
1200A	5A	15VA	65mm

RLC 80

I (pri)	I (sec)	Cl:1	PRIMARY BAR
600A	5A	15VA	80mmX50mm
800A	5A	15VA	80mmX50mm
1000A	5A	15VA	80mmX50mm
1200A	5A	15VA	80mmX50mm
1600A	5A	15VA	80mmX50mm
2000A	5A	15VA	80mmX50mm

RLC 125

I (pri)	I (sec)	Cl:1	PRIMARY BAR
1200A	5A	15VA	125mmX50mm
1600A	5A	15VA	125mmX50mm
2000A	5A	15VA	125mmX50mm
2500A	5A	15VA	125mmX50mm
3000A	5A	15VA	125mmX50mm
3200A	5A	15VA	125mmX50mm
4000A	5A	15VA	125mmX50mm

Technical features

SPECIFICATIONS	
Reference specification	EN/IEC 61869-1, 61869-2
Rated primary current Ipr:	30A TO 4000A
Working frequency:	47...63Hz
Rated continuous thermal current Icth:	100% Ipr
Rated short-time thermal current Ith:	< 60Ipr
Rated dynamic current Idyn:	2,5Ith
Instrument security factor (FS):	≤ 5
Rated secondary current Isr:	5
Max. power dissipation	≤ 20W
Allowed max cable or busbar temperature:	125°C
INSULATION REQUIREMENTS	
Type	Dry transformer, air insulation
Highest voltage for equipment Um:	0.72kV r.m.s.
Rated insulation level:	3kV r.m.s. 50Hz/1min
ENVIRONMENTAL CONDITIONS	
Nominal temperature range:	-25...50°C
Limit temperature range for storage:	-40...85°C
Relative humidity:	≤ 85%
Suitable for tropical climates	yes
CONNECTION	
Primary winding:	Passing bus bar
Secondary winding:	tightening by nut M4
MECHANICAL FEATURES	
Housing material:	self extinguishing polycarbonate
Mounting:	screw type on bar
Weight:	-

Dimensions RLC

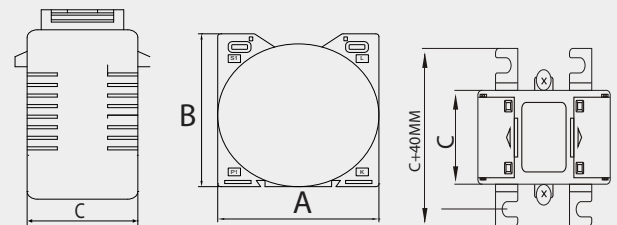

Wiring diagrams

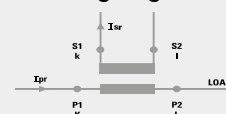

MODEL	A. (mm)	B (mm)	C (mm)
RLC 30	92	98	55
RLC 50	92	98	55
RLC 65	106	112	55
RLC 80	142	124	55
RLC 125	186	124	55

RLC 30



RLC 50



RLC 65

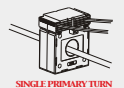

SINGLE PRIMARY TURN

RLC 80

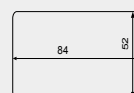

RLC 125

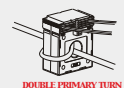
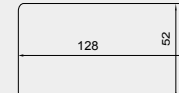

DOUBLE PRIMARY TURN

NOTE: On request orders for types different from table are accepted. 1A Secondary available



FICO hi-tech (pvt) ltd
power of applied intelligence

FICO street climaxabad, GT road, gujranwala, Pakistan.

TEL. (0092) 55325553-4
MOB. (0092) 3217422155
E-MAIL sales@fichohitech.com
WEBSITE www.fichohitech.com





SINCE 1952



Current transformers - Special category

Cable/passing bar single-phase current transformers

SCLC SPLIT (CLAMP TYPE) CURRENT TRANSFORMER



MODEL	Ratio	Class 3	Class 1	Class 0.5	A	B	C	D	E
SCLC -23	100/5A	1.5VA	-	-	30	20	110	90	40
SCLC -23	200/5A	2.5VA	1.5VA	1.25VA	30	20	110	90	40
SCLC -23	300/5A	3.75VA	2.5VA	1.5VA	30	20	110	90	40
SCLC -23	400/5A	5VA	3.75VA	2.5VA	30	20	110	90	40
SCLC -58	300/5A	3.75VA	2.5VA	1.5VA	80	50	145	115	40
SCLC -58	400/5A	3.75VA	2.5VA	1.5VA	80	50	145	115	40
SCLC -58	600/5A	7.5VA	5VA	2.5VA	80	50	145	115	40
SCLC -58	800/5A	7.5VA	5VA	3.75VA	80	50	145	115	40
SCLC -58	1000/5A	12.5VA	10VA	5VA	80	50	145	115	40
SCLC -88	300/5A	2.5VA	1.5VA	1VA	80	80	145	145	40
SCLC -88	400/5A	3.75VA	2.5VA	1.5VA	80	80	145	145	40
SCLC -88	600/5A	5VA	3.75VA	2.5VA	80	80	145	145	40
SCLC -88	800/5A	7.5VA	5VA	3.75VA	80	80	145	145	40
SCLC -88	1000/5A	12.5VA	10VA	7.5VA	80	80	145	145	40
SCLC -812	600/5A	3.75VA	2.5VA	1.5VA	120	80	185	145	40
SCLC -812	800/5A	5VA	3.75VA	2.5VA	120	80	185	145	40
SCLC -812	1000/5A	10VA	7.5VA	5VA	120	80	185	145	40
SCLC -812	1200/5A	12.5VA	10VA	5VA	120	80	185	145	40
SCLC -812	1600/5A	12.5VA	10VA	7.5VA	120	80	185	145	40
SCLC -816	1600/5A	12.5VA	10VA	5VA	160	80	245	185	40
SCLC -816	2000/5A	12.5VA	10VA	7.5VA	160	80	245	185	40
SCLC -816	2500/5A	30VA	25VA	15VA	160	80	245	185	40
SCLC -816	3000/5A	30VA	25VA	20VA	160	80	245	185	40
SCLC -816	4000/5A	30VA	25VA	20VA	160	80	245	185	40
SCLC -816	5000/5A	30VA	25VA	20VA	160	80	245	185	40

Technical features

SPECIFICATIONS	
Reference specification	EN/IEC 61869-1, 61869-2
Rated primary current I _{pr} :	100A TO 6000A
Working frequency:	47...63Hz
Rated continuous thermal current I _{cth} :	100% I _{pr}
Rated short-time thermal current I _{th} :	< 60 I _{pr}
Rated dynamic current I _{dyn} :	2.5 I _{th}
Instrument security factor (FS):	≤ 5
Rated secondary current I _{sr} :	5
Max. power dissipation	≤ 20W
Allowed max cable or busbar temperature:	125°C
INSULATION REQUIREMENTS	
Type	Dry transformer, air insulation
Highest voltage for equipment U _m :	0.72kV r.m.s.
Rated insulation level:	3kV r.m.s. 50Hz/1min
ENVIRONMENTAL CONDITIONS	
Nominal temperature range:	-25...50°C
Limit temperature range for storage:	-40...85°C
Relative humidity:	≤ 85%
Suitable for tropical climates	yes
CONNECTION	
Primary winding:	Passing bus bar
Secondary winding:	tightening by nut M4
MECHANICAL FEATURES	
Housing material:	self extinguishing polycarbonate
Mounting:	screw type on bar
Weight:	

Wiring diagrams

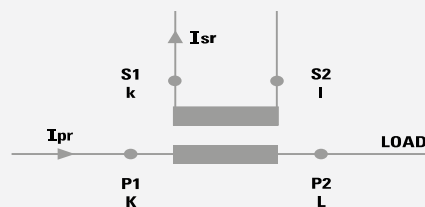

DIMENSIONS

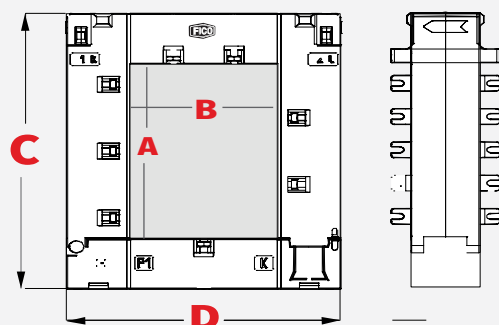

NOTE: On request orders for types different from table are accepted. 1A Secondary available

FICO hi-tech (pvt) ltd

power of applied intelligence

FICO street dimaxabad, GT road, gujranwala, Pakistan.

TEL: (0092) 5532553-4
 MOB: (0092) 3217422155
 E-MAIL: sales@ficohitech.com
 WEBSITE: www.ficohitech.com

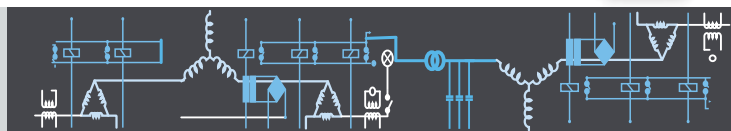



SINCE 1952

Current transformers - SDH & TAB series RECTANGULAR MODEL



Cable/passing bar single-phase current transformers



MODEL (INNER WINDOW SIZE)	Ip (primary)	Is (secondary)	Class 1	Class 0.5	Protection class 5p10
SDH - 130 X 80	3000/5A	5A/1A	10VA - 15VA	7.5VA-10VA	10VA - for Is=5A
SDH - 130 X 80	4000/5A	5A/1A	15VA - 22.5VA	10VA - 15VA	10VA - for Is=5A
SDH - 130 X 80	5000/5A	5A/1A	15VA - 30VA	15VA-22.5VA	10VA - for Is=5A
SDH - 130 X 80	6000/5A	5A/1A	15VA - 45VA	15VA-30VA	10VA - for Is=5A
SDH - 130 X 80	8000/5A	5A/1A	30VA - 60VA	30VA-45VA	10VA - for Is=5A
SDH - 150 X 110	4000/5A	5A/1A	10VA - 15VA	7.5VA-10VA	10VA - for Is=5A
SDH - 150 X 110	5000/5A	5A/1A	15VA - 22.5VA	10VA - 15VA	10VA - for Is=5A
SDH - 150 X 110	6000/5A	5A/1A	15VA - 30VA	15VA-22.5VA	10VA - for Is=5A
SDH - 150 X 110	8000/5A	5A/1A	15VA - 45VA	15VA-30VA	10VA - for Is=5A
SDH - 150 X 110	10,000/5A	5A/1A	30VA - 60VA	30VA-45VA	10VA - for Is=5A
SDH - 50 X 150	3000A-10000A	5A/1A	10VA - 15VA	7.5VA-10VA	10VA - for Is=5A
SDH - 100 X 265	3000A-10000A	5A/1A	15VA - 22.5VA	10VA - 15VA	10VA - for Is=5A
SDH - 65 X 265	3000A-10000A	5A/1A	10VA - 15VA	7.5VA-10VA	10VA - for Is=5A
TAB SERIES	Ip (primary)	Is (secondary)	Class 1	Class 0.5	Protection class 5p10
TAB 3 - 60 X 20	8000/5A	5A/1A	10VA - 15VA	7.5VA-10VA	10VA - for Is=5A
TAB 3 - 60 X 20	3000/5A	5A/1A	15VA - 22.5VA	10VA - 15VA	10VA - for Is=5A
TAB 3 - 60 X 20	4000/5A	5A/1A	10VA - 15VA	7.5VA-10VA	10VA - for Is=5A
TAB 3 - 60 X 20	5000/5A	5A/1A	15VA - 22.5VA	10VA - 15VA	10VA - for Is=5A
TAB 3 - 60 X 20	6000/5A	5A/1A	10VA - 15VA	7.5VA-10VA	10VA - for Is=5A
TAB 3 - 60 X 20	4000/5A	5A/1A	15VA - 22.5VA	10VA - 15VA	10VA - for Is=5A
TAB 3 - 60 X 20	5000/5A	5A/1A	10VA - 15VA	7.5VA-10VA	10VA - for Is=5A
TAB 3 - 60 X 20	6000/5A	5A/1A	15VA - 22.5VA	10VA - 15VA	10VA - for Is=5A
TAB 3 - 60 X 20	4000/5A	5A/1A	10VA - 15VA	7.5VA-10VA	10VA - for Is=5A
TAB 3 - 60 X 20	5000/5A	5A/1A	15VA - 22.5VA	10VA - 15VA	10VA - for Is=5A
TAB 3 - 60 X 20	6000/5A	5A/1A	10VA - 15VA	7.5VA-10VA	10VA - for Is=5A
TAB 3 - 60 X 20	4000/5A	5A/1A	15VA - 22.5VA	10VA - 15VA	10VA - for Is=5A
TAB 3 - 60 X 20	5000/5A	5A/1A	10VA - 15VA	7.5VA-10VA	10VA - for Is=5A
TAB 3 - 60 X 20	6000/5A	5A/1A	15VA - 22.5VA	10VA - 15VA	10VA - for Is=5A
TAB 3 - 60 X 20	4000/5A	5A/1A	10VA - 15VA	7.5VA-10VA	10VA - for Is=5A
TAB 3 - 60 X 20	5000/5A	5A/1A	15VA - 22.5VA	10VA - 15VA	10VA - for Is=5A
TAB 3 - 60 X 20	6000/5A	5A/1A	10VA - 15VA	7.5VA-10VA	10VA - for Is=5A

Technical features

SPECIFICATIONS	
Reference specification	EN/IEC 61869-1, 61869-2
Rated primary current Ipr:	100A TO 10,000A
Working frequency:	47...63Hz
Rated continuous thermal current Icth:	100% Ipr
Rated short-time thermal current Ith:	< 60Ipr
Rated dynamic current Idyn :	2,5Ith
Instrument security factor (FS):	≤ 5
Rated secondary current Isr :	5
Max. power dissipation	≤ 20W
Allowed max cable or busbar temperature:	125°C
INSULATION REQUIREMENTS	
Type	Dry transformer, air insulation
Highest voltage for equipment Um:	0.72kV r.m.s.
Rated insulation level:	3kV r.m.s. 50Hz/1min
ENVIRONMENTAL CONDITIONS	
Nominal temperature range:	-25...50°C
Limit temperature range for storage:	-40...85°C
Relative humidity:	≤ 85%
Suitable for tropical climates	yes
CONNECTION	
Primary winding:	Passing bus bar
Secondary winding:	tightening by nut M4
MECHANICAL FEATURES	
Housing material:	self extinguishing polycarbonate
Mounting:	screw type on bar
Weight:	-

Dimensions (outer)

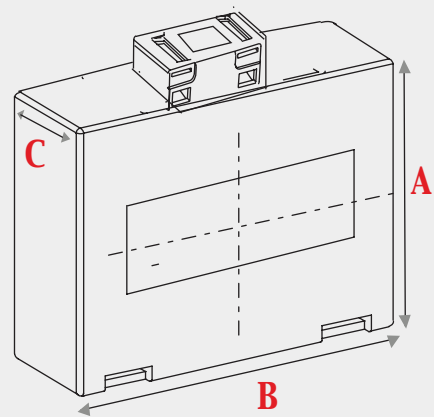

Model	A (mm)	B (mm)	C (mm)
SDH 80X130	180	190	50
SDH 110X150	220	204	60
SDH 100X265	200	300	65
SDH 50X155	145	200	50
SDH 65X225	170	270	55
TLC-3	116	100	50
TLC-4	100	120	45
TLC-5	135	170	50

NOTE: On request orders for types different from table are accepted. 1A Secondary available



FICO hi-tech (pvt) ltd
power of applied intelligence

FICO street climaxabad, GT road, gujranwala, Pakistan.

TEL: (0092) 55325553-4
MOB: (0092) 3217422155
E-MAIL: sales@ficohiotech.com
WEBSITE: www.ficohiotech.com





SINCE 1952

Current transformers - Special category

Cable/passing bar single-phase current transformers



**RESIN
ENCAPSULATED
OUT DOOR
ANTI-THEFT CT**

MODEL	Ratio	Class 0.5	5P10 (PROTECTION)	A	B	C	D
MLC -30	100/5A	15VA	5VA	30	30	138	110
MLC -30	200/5A	17.5VA	10VA	30	30	138	110
MLC -30	300/5A	20VA	12.5VA	30	30	138	110
MLC -30	400/5A	25VA	15VA	30	30	138	110
MLC -60	100-300/5A	15VA-25VA	5VA	60	60	163	110
MLC -60	400/5A	30VA	15VA	60	60	163	110
MLC -60	600/5A	35VA	17.5VA	60	60	163	110
MLC -60	800/5A	40VA	20VA	60	60	163	110
MLC -75	400/5A	50VA	25VA	75	75	165	110
MLC -75	600/5A	60VA	25VA-50VA	75	75	165	110
MLC -75	800/5A	60-100VA	25VA-50VA	75	75	165	110
MLC -75	1000/5A	60-120VA	25VA-50VA	75	75	165	110
MLC -100X125	1000/5A	50VA	25VA	100	125	233	205
MLC -100X125	2000/5A	60VA	25VA-50VA	100	125	233	205
MLC -100X125	3000/5A	60-100VA	25VA-50VA	100	125	233	205
MLC -100X125	4000/5A TO 6000/5A	60-120VA	25VA-50VA	100	125	233	205
MLC -50X125	1000/5A	50VA	25VA	50	125	165	190
MLC -50X125	2000/5A	60VA	30VA	50	125	165	190
MLC -50X125	3000/5A	60-100VA	30VA	50	125	165	190
MLC -50X125	4000/5A	60-120VA	30VA	50	125	165	190
MLC -75X125	1000/5A	50VA	25VA	75	125	200	200
MLC -75X125	2000/5A	60VA	30VA	75	125	200	200
MLC -75X125	3000/5A	60-100VA	30VA	75	125	200	200
MLC -75X125	4000/5A TO 6000/5A	60-120VA	30VA	75	125	200	200

Technical features

SPECIFICATIONS	
Reference specification	EN/IEC 61869-1, 61869-2
Rated primary current Ipr:	100A TO 6000A
Working frequency:	47...63Hz
Rated continuous thermal current Icth:	100% Ipr
Rated short-time thermal current Ith:	< 60Ipr
Rated dynamic current Idyn:	2,5Ith
Instrument security factor (FS):	≤ 5
Rated secondary current Isr:	5
Max. power dissipation	≤ 20W
Allowed max cable or busbar temperature:	125°C
INSULATION REQUIREMENTS	
Type	Dry transformer, air insulation
Highest voltage for equipment Um:	0.72kV r.m.s.
Rated insulation level:	3kV r.m.s. 50Hz/1min
ENVIRONMENTAL CONDITIONS	
Nominal temperature range:	-25...50°C
Limit temperature range for storage:	-40...85°C
Relative humidity:	≤ 85%
Suitable for tropical climates	yes
CONNECTION	
Primary winding:	Passing bus bar
Secondary winding:	tightening by nut M4
MECHANICAL FEATURES	
Housing material:	self extinguishing polycarbonate
Mounting:	screw type on bar
Weight:	

DIMENSIONS

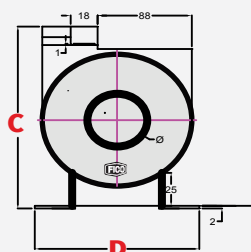

MLC 30 & MLC 60, MLC 75

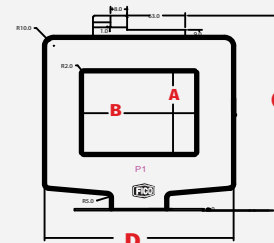

MLC 100 MLC 125

Wiring diagrams

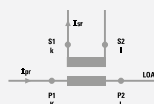

NOTE: On request orders for types different from table are accepted. 1A Secondary available

FICO hi-tech (pvt) ltd
power of applied intelligence

FICO street climaxabad, GT road, gujranwala, Pakistan.

TEL. (0092) 55325553-4
MOB. (0092) 3217422155
E-MAIL sales@fichohitech.com
WEBSITE www.fichohitech.com



made in Pakistan



SINCE 1952



Current transformers - Special category

Cable/passing bar single-phase current transformers



ZERO SEQUENCE CBCT CURRENT TRANSFORMER (MLC RESIN TYPE)

Zero-sequence CT is made to work with microcomputer protection device, motor protection device, and relay, as a ground fault protection set, protecting and monitoring power supply and distribution systems. Rectangular window. Mainly suitable for single or multiple bus-bar applications. High accuracy class and large burden rating. Easy installation (onto the bus-bar). For power supply and distribution systems of up to 660V.

Technical features

SPECIFICATIONS	
Reference specification	IEC 60044-1; IEC 61869-2; NTC 2205; ANSI C57.13; GB1208-2006
Rated primary current I _{pr} :	100A TO 6000A
Working frequency:	47...63Hz
Rated continuous thermal current I _{cth} :	100% I _{pr}
Rated short-time thermal current I _{th} :	< 60I _{pr}
Rated dynamic current I _{dyn} :	2,5I _{th}
Accuracy class for protection/ metering:	5p10, 10p10, 5p20, 10p20, 0.2s, 0.5
Rated secondary current I _s :	5A /1A
burden	≤ 25va
Allowed max cable or busbar temperature:	125°C
INSULATION REQUIREMENTS	
Type	Dry transformer, air insulation
Highest voltage for equipment U _m :	0.72kV r.m.s.
Rated insulation level:	3kV r.m.s. 50Hz/1min
ENVIRONMENTAL CONDITIONS	
Nominal temperature range:	-25...50°C
Limit temperature range for storage:	-40...85°C
Relative humidity:	≤ 85%
Suitable for tropical climates	yes
CONNECTION	
Primary winding:	Passing bus bar
Secondary winding:	tightening by nut M4
MECHANICAL FEATURES	
Housing material:	MLC RESIN TYPE
Mounting:	screw type on bar
Weight:	

Wiring diagrams

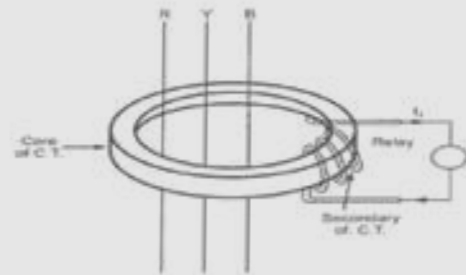

FICO HI-TECH (PVT) LTD DATA SHEET

NOTE: On request orders for types different from table are accepted. 1A Secondary available



made
in
Pakistan

FICO hi-tech (pvt) ltd

power of applied intelligence

FICO street climaxabad, GT road, gujranwala, Pakistan.

TEL: (0092) 55325553-4
MOB: (0092) 3217422155
E-MAIL: sales@ficohitech.com
WEBSITE: www.ficohitech.com

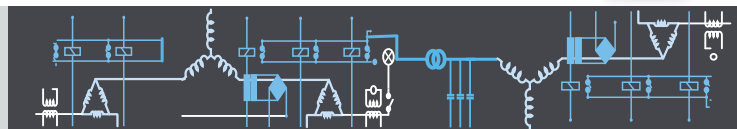



Device overview - summation current transformer, class 0.5

Type	Primary current in A	Secondary current in A	Power in VA	Transformation ratio
FCT-SUM-1	5+5	5	15	1:1
FCT-SUM-2	5+5+5	5	15	1:1:1
FCT-SUM-3	5+5+5+5	5	15	1:1:1:1

Summation current transformers enable a single electricity meter to monitor the total load across a number of supplies. Each supply is fitted with ordinary current transformers, and the secondary leads are then connected to a summation transformer. The secondary terminals of the summation transformer are then connected to the meter. The meter is thus presented with a signal which represents the total for all the circuits connected to the summation transformer. When summation transformers are used it is not possible to determine the individual contribution from each supply.

A separate summation transformer is required for each phase. For single-phase installations it is permissible to use one summation transformer so long as all the circuits are connected to the same phase..

Summation transformers can be manufactured with between two and ten input circuits. It is not good practice to use a summation transformer with more inputs than the number of circuits to be metered. This is because unused circuits can introduce stray signals and can also reduce the dynamic range available to circuits that are connected. If an input to a summation transformer needs to be temporarily disconnected (during fault-finding, for example) the relevant P1 and P2 connections should be shorted together. All the input circuits must have the same ratio. The output from a summation CT with mismatched inputs (e.g. 200 + 300 + 250 : 5A) would be unpredictable and therefore unsuitable for metering.

Technical features

SPECIFICATIONS

Reference specification	EN/IEC 61869-1, 61869-2
Rated primary current I _{pr} :	
Working frequency:	47...63Hz
Rated continuous thermal current I _{ct} :	100% I _{pr}
Rated short-time thermal current I _{th} :	< 60I _{pr}
Rated dynamic current I _{dyn} :	2,5I _{th}
Instrument security factor (FS):	≤ 5
Rated secondary current I _{sr} :	5 - 1A
Max. power dissipation	≤ 19W
Allowed max cable or busbar temperature:	125°C

INSULATION REQUIREMENTS

Type	Dry transformer, air insulation
Highest voltage for equipment U _m :	0.72kV r.m.s.
Rated insulation level:	3kV r.m.s. 50Hz/1min

ENVIRONMENTAL CONDITIONS

Nominal temperature range:	-25...50°C
Limit temperature range for storage:	-40...85°C
Relative humidity:	≤ 85%
Suitable for tropical climates	yes

CONNECTION

Primary winding:	
Secondary winding:	tightening by nut M4

MECHANICAL FEATURES

Housing material:	self extinguishing polycarbonate
Mounting:	screw type on bar
Weight:	

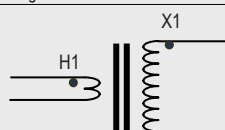

Current transformer polarity can be defined by permanent markings (typically H 1 – X 1) or polarity dots.

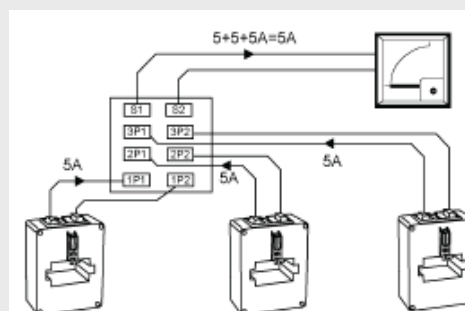
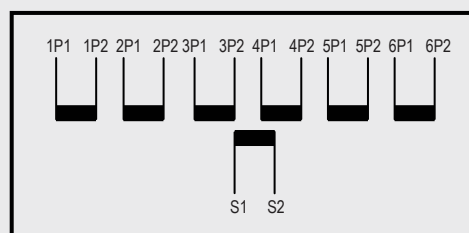

NOTE: On request orders for types different from table are accepted. 1A Secondary available

Push button series FPB MODEL

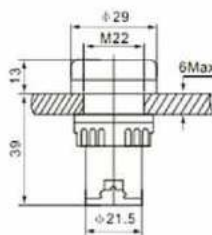
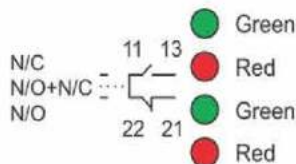

FBP-22 PUSH BUTTON

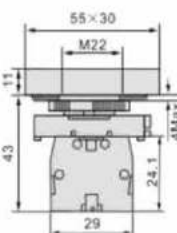
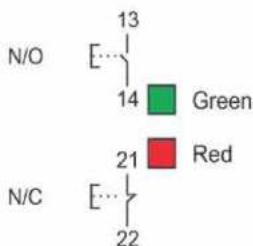

FPBGR-NOC

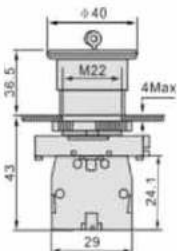
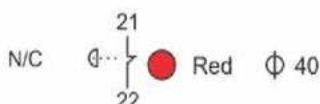

FMHB-TR

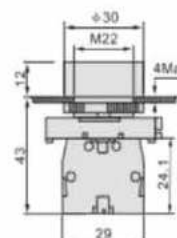
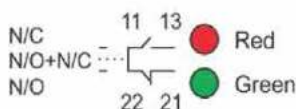

FPBG-B-NC
FPBG-B-NOC

PUSH BUTTON WITH BASE
Additional feature: with metal enclosing

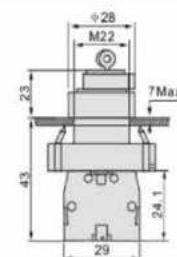
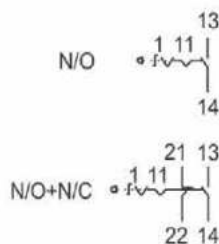

FPB-LH
FPB-KL

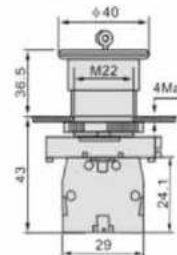
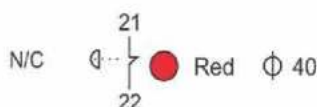

FMHB-KL

PUSHBUTTON:

- NON-ILLUMINATED
- Protection type IP67, IP69K

Push Buttons are available in a variety of custom markings.

Modular construction makes assembly fast and simplifies stocking of components and complements.



INTERNAL MECHANICS OF PUSHBUTTON

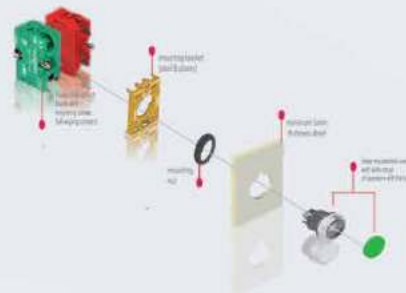

22mm Specifications

Electrical and Mechanical Characteristics

Standard conformity: Approvals:	IEC 60947-5-1 VDE0430 CSA - C22.2 No. 14-95 UL508 IEC 947-5 (1) 1990, 10 1994 ACB UK certified as per IEC 947-5 (1) 1990 IP 65 as per IEC 529 NEMA type 4X, 12 as per UL99 -20°C to +70°C (-30°F to +158°F)
Degree of protection:	
Temperature range:	
Contact Block	
Rated voltage:	600V AC/DC
Rated current:	10A AC / 2.5A DC
Contact operation: (UL508 testing split duty) CSA - C22.2 No. 14-95	self-wiping, slow break NO or NC
Make and break capacity: IEC 947-5 (1) 1990	AC 15-4A, 415V AC DC 13.6SA, 110V DC
Terminal capacity:	minimum 20 AWG (0.5 mm ²) maximum 24 AWG (0.5 mm ²) 1-2 for IEC, 3-4 for HQ
Terminal marking:	10A cartridge fuse HRC type, rated for resistive loads
Short circuit protection:	
Mechanical life:	1 million operations





SINCE 1952

SELECTOR SWITCH



Product Introduction

The FICO series rotary switch mainly applies to 440V and below AC 50Hz or 240V and below DC circuits. For breaking and closing, change-over of circuits under unfrequently manual operation. And the typical application are: controls of 3 phase motors, controls of switch gear, control switch of instruments, and change-over switch of machinery and welding machine.

The series comply with IEC 60947-3 & IEC 60947-5-1.

The FS (FICO) series have 8 current ratings: 0A, 20A, 25A, 32A, 40A, 63A

Working conditions

- (1) Ambient temperature DO NOT exceed 40°C, and the average temperature, measured over a period of 24 hours, DO NOT exceed 35°C.
- (2) Ambient temperature should not be below -25°C.
- (3) Should not be installed above 2000m above sea level.
- (4) The humidity should not exceed 50% when the ambient temperature is 40°C and higher humidity is allowed for lower temperature.

Installation conditions

- (1) A clean environment is required.
- (2) Please follow our manual.

DIMENSIONS & INSTALLATION

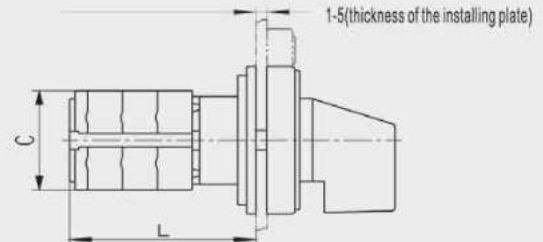
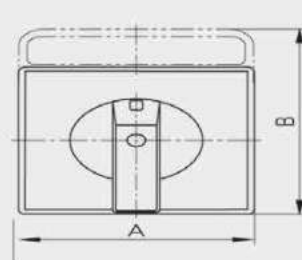

Specification	Escutcheon plate	Dimensions (mm)				Installation (mm)			
		A	B	C	L	E	F	D1	D2
FS 26-20	M1 square	48	48	43	22+9.6n	36	36	ø 8.5	ø 4.5
FS 26-20	M1 rectangular	48	60	43	22+9.6n	36	36	ø 8.5	ø 4.5
FS 26-20	M2 square	64	64	43	25+9.6n	48	48	ø 10	ø 4.5
FS 26-20	M2 rectangular	64	80	43	25+9.6n	48	48	ø 10	ø 4.5
FS 26-32	M2 square	64	64	58	29.2+12.8n	48	48	ø 10	ø 4.5
FS 26-32	M2 rectangular	64	80	58	29.2+12.8n	48	48	ø 10	ø 4.5
FS 26-63	M3 square	88	88	58	29.2+12.8n	68	68	ø 13	ø 6
FS 26-63	M3 square	64	64	66	29.2+21.5n	48	48	ø 10	ø 4.5
FS 26-63	M2 rectangular	64	80	66	29.2+21.5n	48	48	ø 10	ø 4.5
FS 26-63	M3 square	88	88	66	29.2+21.5n	68	68	ø 13	ø 6

Dimension and Installation

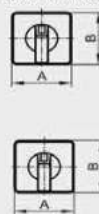

Voltmeter Selector Switches

Prog No	Description	Script Plate Marking/ Operating Quadrant	Connecting Diagrams/Terminal Marking	No. of Stages
01312	3-Phase Line to Line			2
01313	3-Phase Line to Line & Line to Neutral			3

Ammeter Selector Switches

Prog No	Description	Script Plate Marking/ Operating Quadrant	Connecting Diagrams/Terminal Marking	No. of Stages
01325	1 Pole - 3 Transformer with C/P			3



Cam Assembly





SINCE 1952

INDICATION LIGHT FIL MODEL



LED Lamp Ratings

Rated Voltage	12V DC, 24V AC/DC, 220V-380 AC
Voltage Range	12V DC $\pm 5\%$, 24V AC/DC $\pm 10\%$, 220V - 380 AC $\pm 10\%$
LED Illumination Color	Red (R), Green (G), Yellow (Y), Blue (S)
Rated Current	12V DC: R, A, Y - 21mA; G, S, PW - 22mA 24V AC/DC, 220V AC: 24mA (all colors)
LED Life (Ref.)	Approx. 30,000 Hrs. at rated voltage @ 25°C in specified environmental conditions (The brightness reduces to 50% of initial value)
Equivalent Circuit	

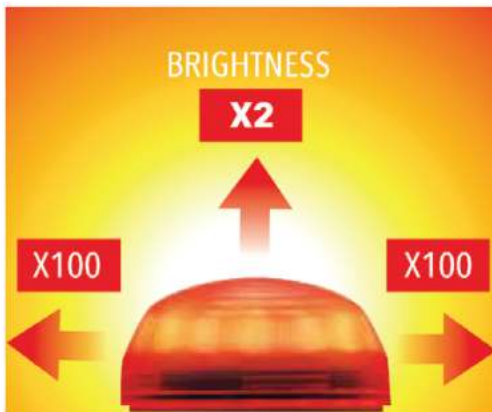

Twice as bright as standard pilot lights when viewed from the front, and up to 100 times brighter than standard pilot lights when viewed from side angles.

Specifications

Rated Operating voltage (AC)	110-380V
Working frequency:	47...63Hz
Rated Operating voltage (DC)	6V - 48V
Rated operational current (mA):	< 20mA
Service life :	> 30,000
Brightness:	> 60
Operating Temperature	- 25 to +55°C (no freezing)
Storage Temperature	-45 to +80°C (no freezing)
Operating Humidity	45-85%RH (no condensation)
Insulation Resistance	100M Ω (DC500V megger)
Over Voltage Category	II (IEC60664-1)
Impulse Dielectric Strength	2.5kV (IEC60664-1, IEC60947-5-1)
Pollution Degree	3 (IEC60947-5-1)
Dielectric Strength	Between terminals of different poles: 2,000V AC, 1 min Between live and non-live parts: 2,000V AC, 1 min
Vibration	Operation limit
Resistance	Damage limit
Shock	Operation limit
Resistance	Damage limit
Degree of Protection	Panel front: IP66 (IEC 60529), UL Type 4X
Terminal Size	M3.5 screw Terminals: IP20
Tightening Torque	Terminal Screw: 1.0Nm Locking Ring: 2.0Nm
Wire Size	AWG16 ~ AWG14, 2 wires max.
Weight (approx.)	18g

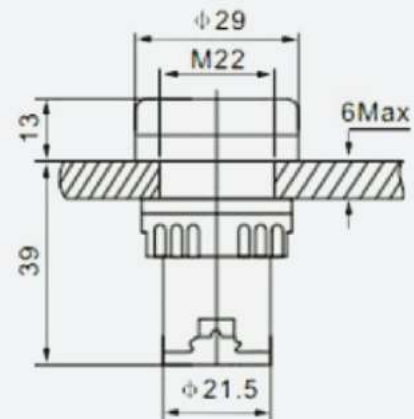

FICO hi-tech (pvt) ltd

power of applied intelligence

FICO street climaxabad, GT road, gujranwala, Pakistan.

TEL: (0092) 5532553-4
MOB: (0092) 3217422155
E-MAIL: sales@fichohitech.com
WEBSITE: www.fichohitech.com





SINCE 1952



DIGITAL & ANALOGUE TYPE METERS



DIGITAL VAF
METER



DIGITAL WATT
METER



DIGITAL FREQUENCY
METER



DIGITAL AMPERE
METER



DIGITAL VOLT
METER



ANALOG
METERS



DIGITAL AMMETER, VOLT METER
(80X80), (60X60)



DIGITAL METER
(96X48)



DIGITAL DIN RAIL
TYPE VA METER



DIGITAL VA METER
(AC 80-300V)



DIGITAL POWER ANALYZER

FDM-PA (96 x 96 x 82) is a power analyzer and meter, It can measure and display all the electrics, Four modules can be plugged-in together: RS-485 communications, digital input/output, energy pulse, and DC 4~20mA analog output, So as to meet all kinds of demands.

Measurement Parameters

Voltage (Ph-N); Voltage (Ph-Ph); Current; Frequency; PF; Active Power(W); Reactive Power(Q); Apparent Power(S)

Accuracy $\pm 0.5\%$

RS-485 interface port support, 32 (128) Networking, ModBus-RTU communication protocol.

AC85~265V / DC85~330V, DC18~90V (optional)

Power Consumption: <4VA

Specification Table for Digital Meters

DIGITAL TYPE METER	VOLT METER	AMPERE METER	FREQUENCY METER	WATT METER	VAF METER	VA METER	DRT METER
FRONT FRAME(MM)	96X96, 72X72 96X48	96X96, 48X48, 96X48	96X96, 72X72,	96X96	96X96	60X60X49	54X80X64
DISPLAY	3 - digit	4 - digit	3 - digit	3 - digit	Ammeter: 3 x 4 digit voltmeter: 3 digit frequency meter: 3 digit	2 - digit	2 - digit
ACCURACY	$\pm 1\% - 2d$	$\pm 1\% - 2d$	$\pm 0.2\% + 2d$	$\pm 1\% - 2d$	Ammeter: $\pm 1\% + 2d$ voltmeter: $\pm 1\% + 2d$ frequency meter: $\pm 0.2\% + 2d$	$\pm 1\% - 2d$	$\pm 1\% - 2d$
MEASURING RANGE	0-500V	0-9999A	20-500 HZ (30 - 500V AC)	0-1250W	Ammeter: 0-9999A voltmeter: 0-500V frequency meter: 30-70 HZ	0-100A 0-500V AC	0-100A 0-500V AC
POWER CONSUMPTION	<3VA	<3VA	<3VA	<3VA	<3VA	<3VA	<3VA

For ammeter ct ratio 1 2000A.

Ambient temperature $-5^{\circ}\text{C} \dots +55^{\circ}\text{C}$

Power supply 230 V AC $\pm 20\%$, 50/60 Hz

IEC standard

Warranty period

2 Years





SINCE 1952

FUSE CUTOUT (POLYMER TYPE)

11kv Fuse cutout for KE



CHARACTERISITCS OF DISTRIBUTION FUSE LINKS

Model/Type of FUSE LINKS	FK-KK-6A, FK-KK-10A, FK-KK-15A, FK-KK-30A, FK-KK-40A
Manufacturing Standard	K-FLDOC-210/2003
Ratings and characteristics of the dropout cutout as per clause 3.0	
Nominal voltage	11 KV
Maximum design voltage	12 KV
Normal Current rating	3,6,15 & 40 Amps
Tensile withstand strength	6 kg
Normal Diameter of flexible leader	2.25MM
Normal Bending diameter of flexible	6MM
RATING PLATE	AS PER SPECS
PACKING	AS PER SPECS

Technical features

Name & address of Manufacturer	FICO HI-TECH (PVT) LTD, FICO STREET CLIMAXABAD, GT ROAD, GUJRANWALA
Country of Origin	PAKISTAN
Model/Type of CTs	DF-PI-11KV
Manufacturing Standard	KDTP-S284-15-00-Silicon

Ratings and characteristics of the dropout cutout as per clause 3.0

Nominal voltage	11 KV
Maximum design voltage	12 KV
Rated continuous current	100A
Interrupting current Assymn Amps(RMS) at	8000A
Impulse withstand voltage to ground	95 KV
Impulse withstand voltage across gaps	110 KV
Dry one minute power frequency Withstand voltage to ground.	35 KV
Dry one minute power frequency Withstand voltage across gap.	45 kv
WET one minute power frequency Withstand voltage to ground.	30 KV

mechanical and electrical characteristics of the Silicon Rubber insulator

Leakage distance	508 mm (min)
Dry arcing distance	170 mm (min)
Hardness (Shore A)	≥58
Elongation at break (%)	≥200
Tear Strength (N/mm)	12.5
Dielectric strength KV/ mm	≥18

Chemical composition and mechanical and electrical properties of materials to be used in housing

Tensile strength (minimum)	45 kg/sq. mm
Yield strength (minimum)	17 kg/sq. mm
Elongation in 50 mm	20%
Electrical conductivity	14% IACS
Brinell hardness No	(3000 kg) load. 110 min
All springs (wires and strips) as per specs	
All ferrous parts & terminal coonectors	AS PER SPECS
fuse holder	AS PER SPECS
RATING PLATE	AS PER SPECS
PACKING	AS PER SPECS



FICO hi-tech (pvt) ltd

power of applied intelligence

FICO street climaxabad, GT road, gujranwala, Pakistan.

TEL: (0092) 55325553-4
MOB: (0092) 3217422155
E-MAIL: sales@fichotech.com
WEBSITE: www.fichotech.com





SINCE 1952

FUSE CUTOUT (POLYMER TYPE)

11kv Fuse cutout for KE



INTRODUCTION:

FICO is manufacturing Fuse Cutout in different designs Used for the protection of Distribution Transformers since 1958.

DESIGN:

FICO has developed a new design with Single Insulator based on ANSI, IEC & WAPDA standards.

MATERIAL:

Current carrying components have been made from aluminum bronze which has weather proof, high tensile, anti-rust properties with excellent conductivity. Fuse carrier assembly has been manufactured with glass fibre tube with vulcanized fibre lining of good electrical and thermal properties. All main contacting faces are silver coated.

INSULATOR:

Brown & White glazed porcelain insulator with food characteristics of electrical and mechanical properties have been used.

MOUNTING:

In order to avoid rust and atmospheric effects all ferrous parts have been galvanized. Mountings are adjustable and can be fixed with any type of cross-arm.

OPERATION:

In case of any fault, Fuse carrier is released automatically which releases upper contact and Fuse carrier drops out conveniently. Thus the identification of the faulty phase of the system can easily be traced. Fuse carrier is easily removable with operating rod for replacement of Fuse Links.

FUSE LINKS:

FICO is also producing Expulsion Fuses Links K - Type & T - Type upto 1 - 100 Amps.

TYPE TEST:

Fuse Cutout Single Insulator has been tested from International Lab KEMA of Holland in accordance with WAPDA Standard.

ROUTINE TEST:

FICO has in-house testing facility to carry out all routine test as per required standards.

RATINGS:

The following ratings have been assigned to Fuse Cutout Single Insulator

Nominal Voltage	11KV
Maximum Design Voltage	15KV
Rated Continuous Current	100Amps
Interrupting Current Asymmetrical (R.M.S)	1,000Amps
Impulse withstand voltage to ground	95KV
Impulse withstand voltage across gaps	110KV
Dry One-Minute Power Frequency withstand voltage to ground	35KV
Dry One-Minute Power Frequency withstand voltage across gaps	45KV
Wet One-Minute Power Frequency withstand voltage to ground	30KV

NO.	DESCRIPTION
1	PORCELAIN INSULATOR
2	MOUNTING BRACKET
3	LONG BOLTS
4	BACK PLATE
5	UPPER HOUSING
6	LOWER HOUSING
7	FUSE HOLDER
8	FUSE LINK

Technical features

Name & address of Manufacturer	FICO HI-TECH (PVT) LTD, FICO STREET CLIMAXABAD, GT ROAD, GUJRANWALA
Country of Origin	PAKISTAN
Model/Type of CTs	DF-PI-11KV
Manufacturing Standard	

Ratings and characteristics of the dropout cutout as per clause 3.0

Nominal voltage	11 KV
Maximum design voltage	12 KV
Rated continuous current	100A
Interrupting current Assym Amps(RMS) at	8000A
Impulse withstand voltage to ground	95 KV
Impulse withstand voltage across gaps	110 KV
Dry one minute power frequency Withstand voltage to ground.	35 KV
Dry one minute power frequency Withstand voltage across gap.	45 kv
WET one minute power frequency Withstand voltage to ground.	30 KV

mechanical and electrical characteristics of the Silicon Rubber insulator

Leakage distance	508 mm (min)
Dry arcing distance	170 mm (min)
Hardness (Shore A)	≥58
Elongation at break (%)	≥200
Tear Strength (N/mm)	12.5
Dielectric strength KV/ mm	≥18

Chemical composition and mechanical and electrical properties of materials to be used in housing

Tensile strength (minimum)	45 kg/sq. mm
Yield strength (minimum)	17 kg/sq. mm
Elongation in 50 mm	20%
Electrical conductivity	14% IACS
Brinell hardness No	(3000 kg) load. 110 min
All springs (wires and strips) as per specs	
All ferrous parts & terminal connectors	AS PER SPECS
fuse holder	AS PER SPECS
RATING PLATE	AS PER SPECS
PACKING	AS PER SPECS

